

1U Rack Mount Enclosure 3 slots LGX (up to 72FO)



Enclosure accepts 3 LGX pass-thru adapter plates for a total of 72FO with LC configuration (36 in SC). Modular panel for multi-application with MTP/MPO System, Pre-terminated cables or conventional splicing. Easy front access with hinged front and rear removable doors as well as lid. Panel is supplied unloaded and the modules and plates are supplied separately.

Features and Applications

- 3 Slots LGX in 1U space
- Up to 72FO in LC
- Modular with MTP Cassette or Adapter plates
- Slide-out tray with spring loaded latch
- Enterprise network & Datacentre
- Indoor application
- Accepts Indoor and Outdoor Pre-terminated cables and MTP/MPO Modules and Splicing

Specifications

General Specifications	
Mounting Type	Rack 19" and optional bracket for 23"
Height Unit	1U
Material	Cold rolled steel
Housing Color	Black
Application	Indoor IP20
Lockable	No
Dimensions (W x D x H in MM)	434x351x33.30
Net Weight	5.9kg

**FIBRE MANAGEMENT
RACK MOUNT
LGX RANGE**

Design - Hardware	
Opening Type	Sliding tray
Access Type	Front & rear access , Removable top cover
Front Cable Management	Removable hinged drop down door
Cable Entry Direction	Sides
Rear Cable Management	Rear hinged drop down door
Slot Type	LGX Modules and LGX Plates
Number of Slots	3
Fiber Capacity	72 in LC

Ordering Information

Part Number Product Description

Picture

MP3PP01 1U Rack Mount Enclosure 3 slots LGX (up to 72FO)
Unloaded



Technical Drawings

Front View

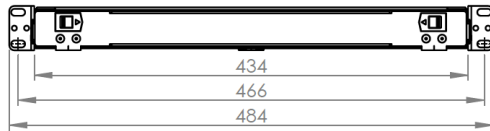

Side View

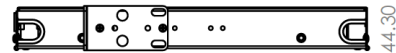

Top View

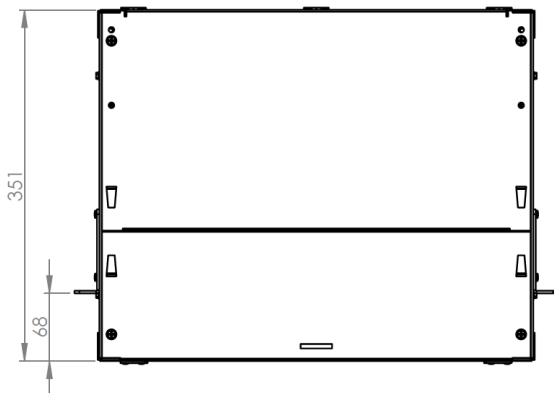

Rear View

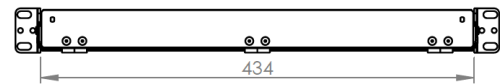

All dimensions in mm

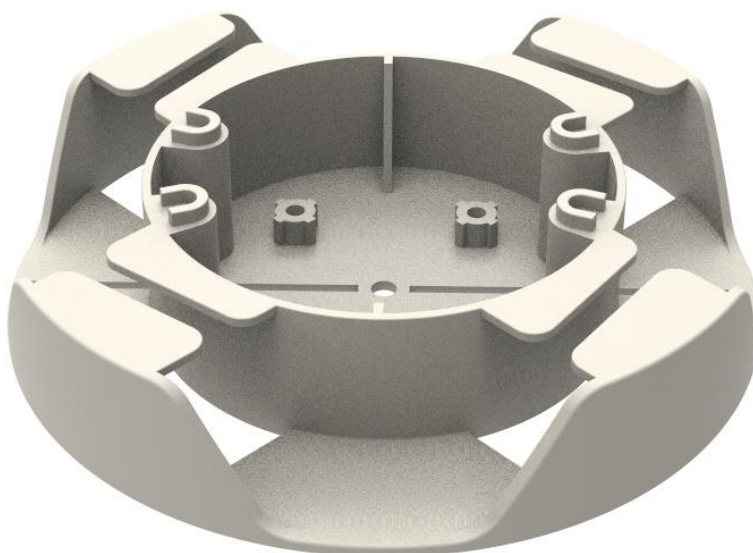

The Nexconec Fiber Spool manages fiber slack in all different type of rack and wall mount enclosures. Fiber retention tabs maintain minimum bend radius control, while rounded edges eliminate the risk of snagging and stress.

Designed to accommodate different cable diameters of up to 3mm, this unit can be split into half to accommodate different fiber routing as well be stacked together thru a simple snap-in.

FEATURES

- Allows easy storage of excess fiber and multidirectional routing of entry and exit fibers.
- Coiling of 250µm, 900µm buffered fibers up to 3mm cables
- Minimum 40mm Bend Radius
- Clips together allowing multiple stacks
- Can be split into half section
- Mountable via screw holes or double sided adhesive pad

APPLICATIONS

- Fiber management
- Internal and external
- Wall boxes
- Patch panels



SPECIFICATION

Parameters	Units	
Dimension (W-H)	mm	100x25
Material – body		ABS Grey RAL7044
Compliance		TIA/EIA, IEC, RoHS, Reach/SVHC

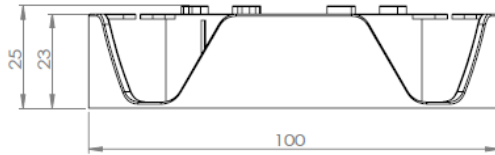
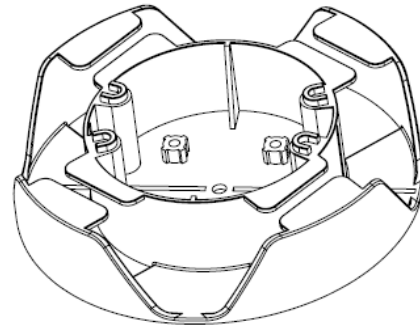
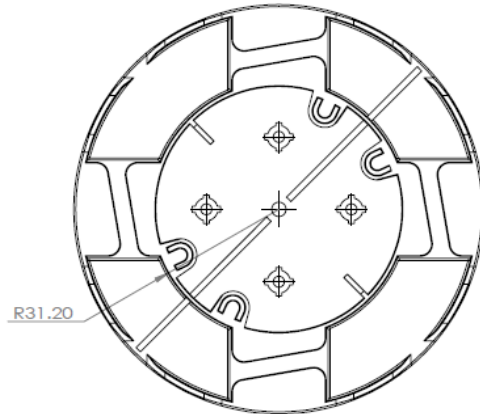

*Patent pending

ORDERING INFORMATION

FSP02 FIBER MANAGER SPOOL

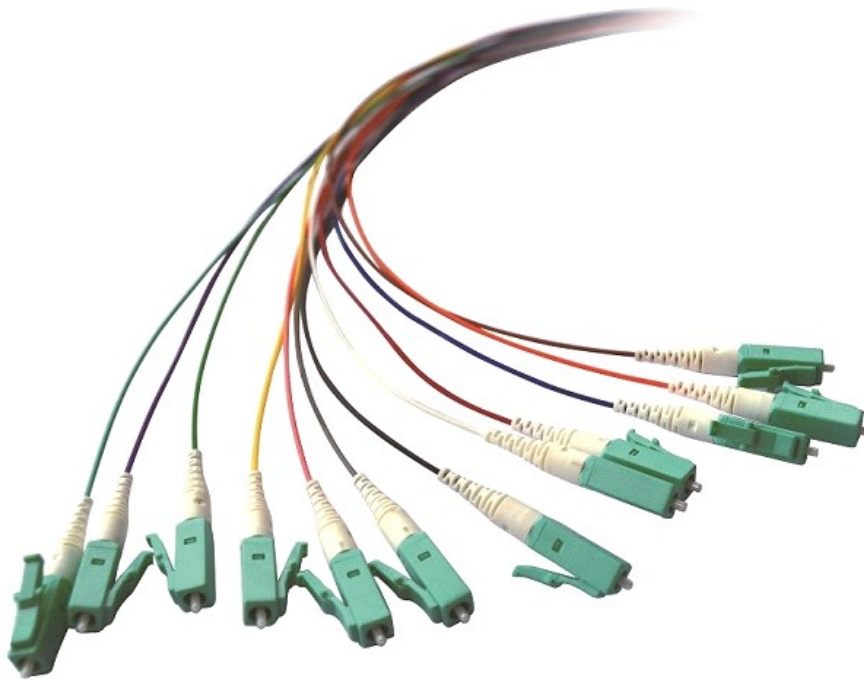

Nexconec pigtails are suitable for telecommunication networks, data processing networks, FTTX, FTTH and some critical applications. The pigtails provide flexible connection inside passive equipments, patch panels, ODFs and closures. We offers diverse range of single fiber ferrule connectors which are manufactured with precision factory mounting and polishing techniques to assure high transmission quality.

FEATURES

- Conform to IEC, EIA-TIA, and Telcordia performance requirements
- Available in standard Singlemode and Multimode fibre types
- LC, SC, FC and ST connector types
- Available in standard and customised length
- Buffer material available as easy strip and tight buffer options
- RoHS, REACH & SvHC compliant, Materials Conflict compliant

APPLICATION

- Telecommunication networks
- Data Processing networks
- FTTX
- Broadband network.
- Fibre-to-the-home



**FIBER OPTIC ASSEMBLY:
PIGTAILS**

CONNECTOR SPECIFICATION

Parameters	Units		Parameters	Units	PC	APC
Insertion loss – Standard	dB	Typ-0.25/ Max < 0.3	ROC -2.5mm	mm	5-30	5-12
Return loss SM (PC/APC)	dB	> 55/65	ROC -1.25mm	mm	5-30	5-12
Insertion loss – Premium	dB	Typ-0.12/ Max < 0.15	Apex offset	µm	0-70	0-70
Return loss SM (PC/APC)	dB	≥ 55/65	Fiber height	nm	-100 - a	-100 - a
			APC angle	degree	-	7.7-8.3

PIGTAIL PERFORMANCE

Mechanical Properties	Criteria	Effect	Standard
Mechanical endurance	500 mating	<0.2 dB change	IEC 61300-2-2
Vibration	10-55 Hz, 0.75 amplitude	<0.2 dB change	IEC 61300-2-1
Drop	Drop height 1m, 5 drops	<0.2 dB change	IEC 61300-2-12

BUFFER CHARACTERISTICS

Characteristics	Units	Simplex
Nominal buffer diameter	mm	900 +50/-50
Crush	N/100mm	500
Operating Temperature	°C	-20 to 60
Maximum tensile load	N	6
Minimum Bending Radius	mm	15

ORDERING INFORMATION

AX 1 2 3 4 5 6 7 8 DIST

1	CONNECTOR	2	FIBRE	5	BUFFER	3	BUFFER TYPE	4	BUFFER COLOR	6	BUFFER MATERIAL	7	QUALITY	8	PERFORMANCE
S1	SC	D2	652D	9	900µm	T	TIGHT	Y	YELLOW	L	LSZH	P	SINGLE	S	STANDARD
S2	SCA	A1	657A1			E	EASY	W	WHITE	C	PVC	S	6 PACK	P	PREMIUM
L1	LC	O3	OM3					R	RAINBOW			T	12 PACK		
L2	LCA	O4	OM4												
F1	FC														
F2	FCA														
T1	ST														



Nexconec splice tray is designed to safely splice 12 or 24 individual fibers which can be installed in rack mount patch panels, wall mount enclosures, terminal box or distribution unit. The splice trays provide security for fusion splicing and can be used with different cable options.

The tray incorporates clamps to secure loose tubes and pigtails on entry and exit.

FEATURES

- Hold up to 12 or 24 heat-shrink splices protectors
- 250µm, 600µm or up to 900µm buffered fibers
- Accommodates 40-45mm heat shrink
- Stackable with individual access available to each splice tray
- Incorporated clamp to secure fibres on entry and exit
- 3 positions mountable holes or adhesive pads
- Transparent lid

APPLICATIONS

- Fiber management
- Internal and external
- Wall boxes
- Patch panels



REAL OPTIC

FIBRE MANAGEMENT
ACCESSORIES
NXC SPLICE TRAY

SPECIFICATION

Parameters	Units	
Dimension	mm	160x130x13.10
Material – body		ABS Grey RAL7044
Material – lid		PVC Transparent

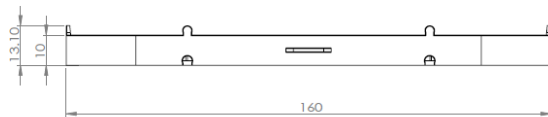
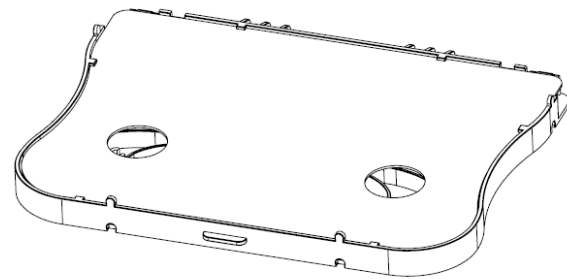
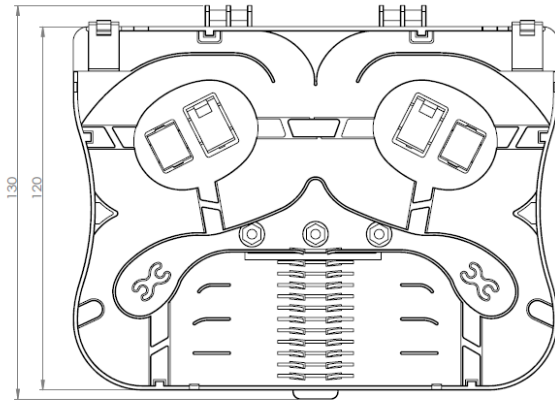

*Patent Pending

ORDERING INFORMATION

FSP01 FIBER OPTIC SPLICE TRAY 24FO